

# Installing the ClickView Plugin for SharePoint

These instructions apply to both SharePoint 2010 and SharePoint 2013.

The ClickView Plugin for SharePoint enables you to quickly and safely browse through your entire ClickView library, the ClickView Exchange and your own personal Workspace from within SharePoint, making it easy to embed educational videos directly into your pages and share them with your students.

1

To install the ClickView plugin for SharePoint, first download it.

[Download the ClickView Plugin for SharePoint](#)

## ClickView Plugin for SharePoint

This plugin integrates with SharePoint and your existing Single Sign On so you can quickly browse through your entire ClickView library, the ClickView Exchange and your personal Workspace from within your LMS.

You can embed videos into your lesson plan with one click and use the fully featured ClickView Web Player to share educational videos with your students.

Download the ClickView plugin for SharePoint

▼ Download

2

Access the SharePoint Management Shell.

This can be found by clicking:  
Start - All Programs - Microsoft SharePoint Products - SharePoint Management Shell

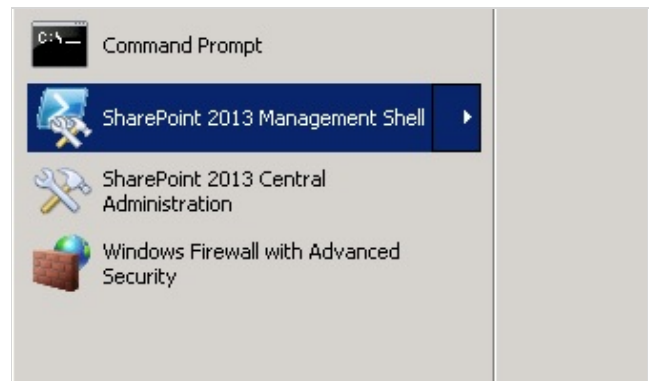

3

Enter the following command:

Add-SPSolution "<directory of the plugin download>"

For example:  
Add-SPSolution "C:\Administrator\SharePoint WebParts\ClickView.Plugins.SharePoint.wsp"

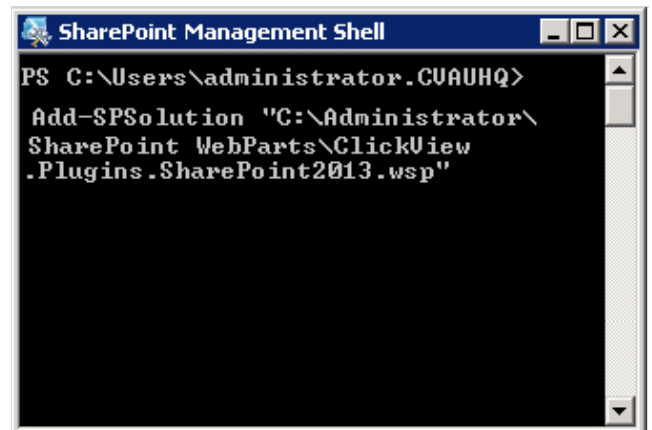

4

Visit the Central Administration page for SharePoint and click 'System Settings'.

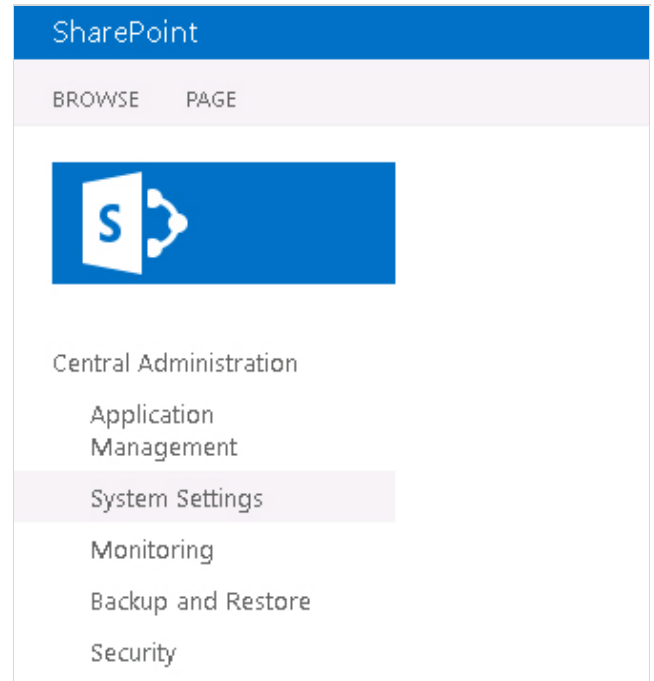

5

Within 'System Settings', click on 'Manage farm solutions'.

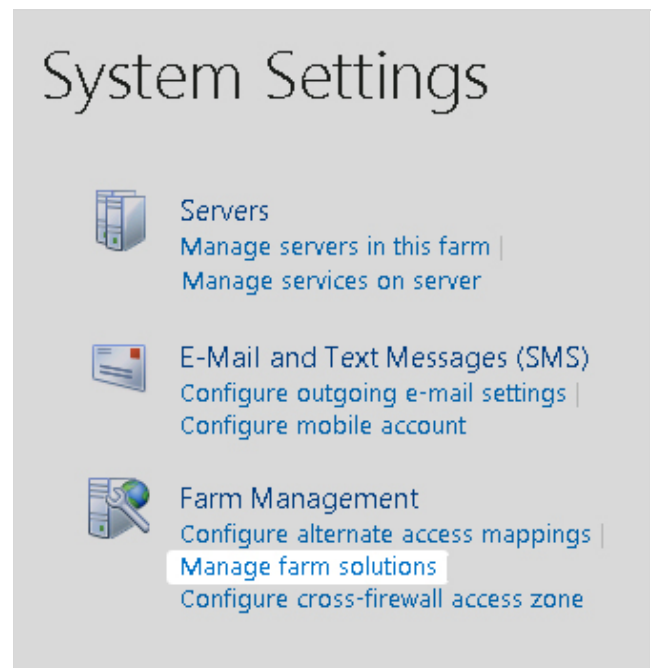

6

Click on the ClickView plugin for SharePoint.

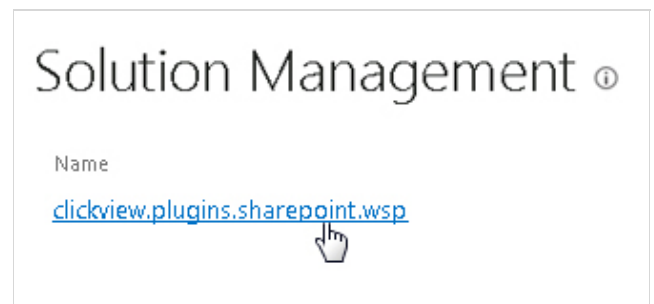

7 Click on 'Deploy Solution'.

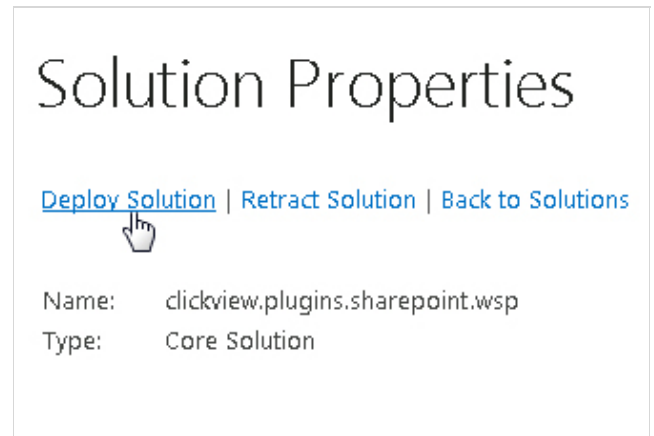

8 You will have the chance to confirm details such as when and where to deploy.  
Click OK when you're ready.

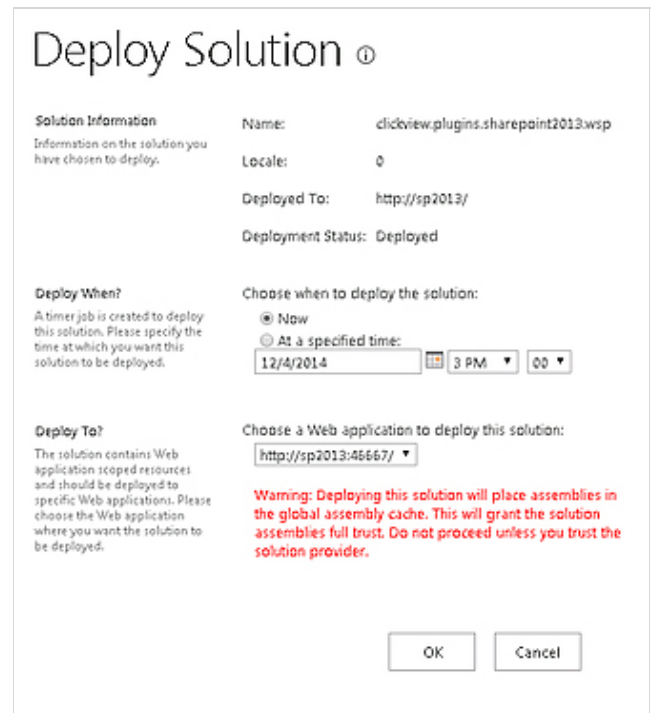

9 You should now be able to see the 'ClickView Video' object within the 'INSERT' tabs of Site Pages.

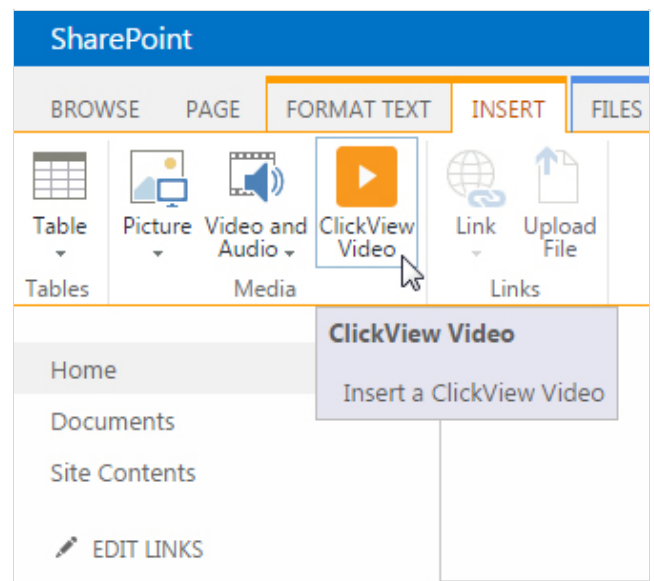

For more information, see [Using the ClickView Plugin for SharePoint](#)